

Appendix 2

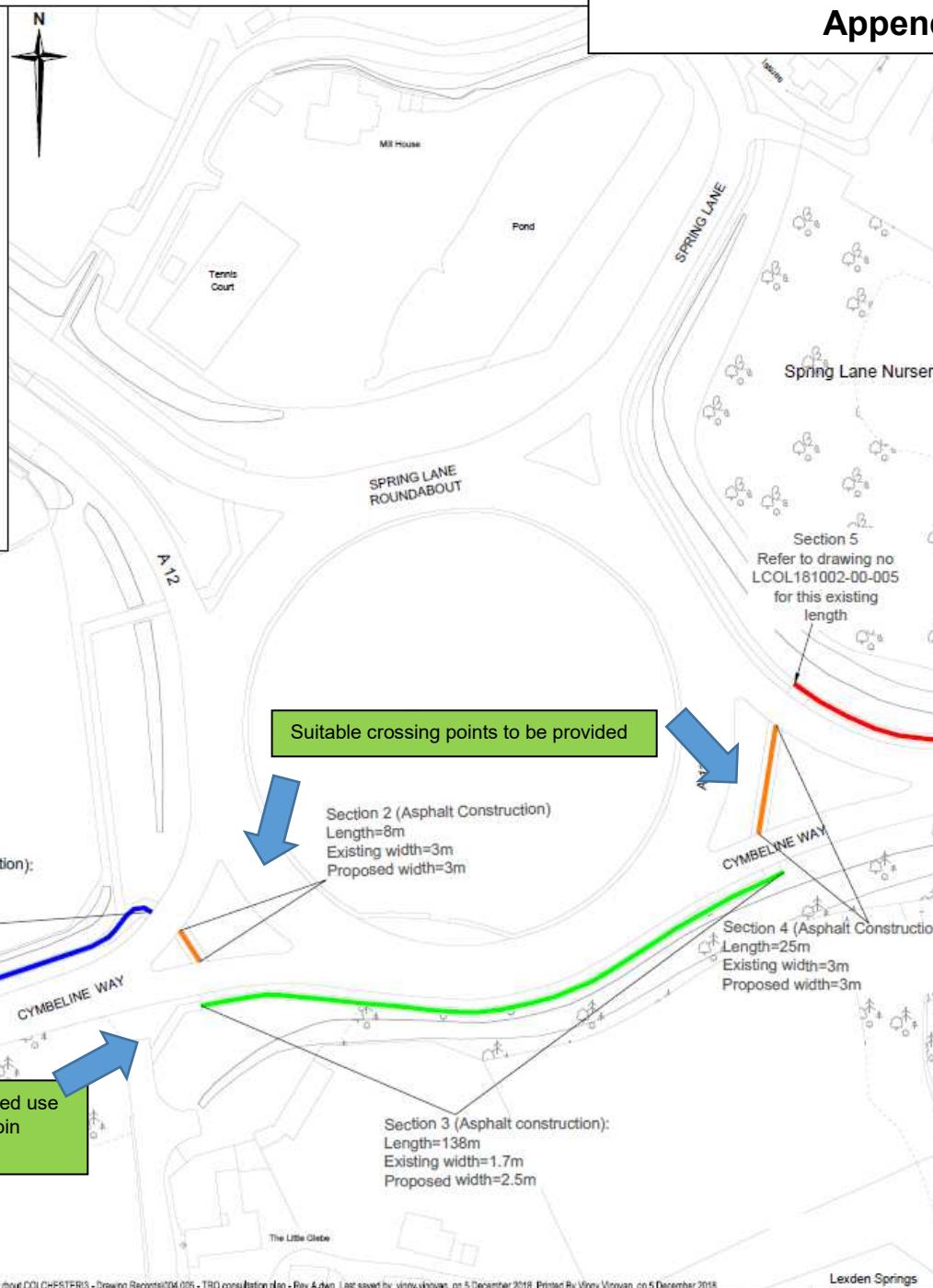
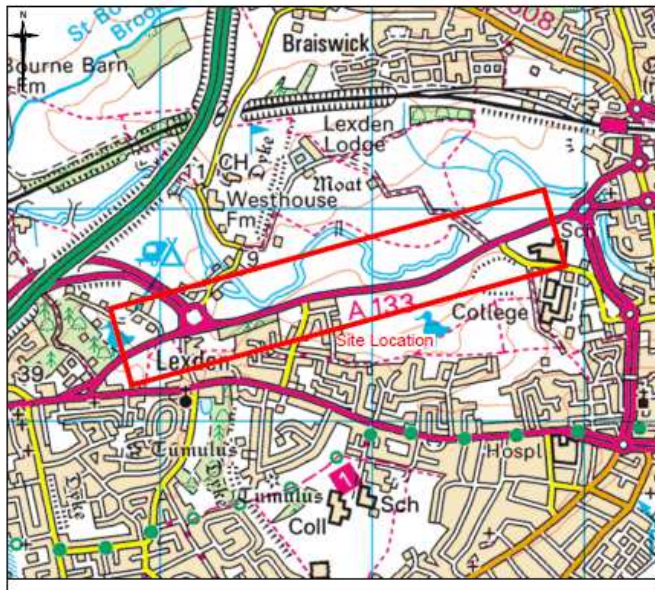

NOTES

1. Do not scale.

Key

- Existing shared use (widened) facility to be advertised
- Existing footway (widened) to be converted to shared use facility
- Existing footway to be converted to shared use facility

CBC comments

Rev	Date	Description of revision	Drawn	Checked	Reviewed	Approved
1						
2						
3						
4						
5						
6						
7						
8						
9						
10						

FOR CONSULTATION

Essex Highways
Essex Highways, Essex House, Victoria Road South, Chelmsford, CM1 1QH.
Tel: 0206 8000000 © Essex County Council

Proposed Safety Improvements
Spring Lane Roundabout, Colchester (LCOL181002)

TRO Consultation Plan
(Sheet 1 of 2)

DESIGNED	DRAWN	CHECKED	REVIEWED	APPROVED
VV	VV	KM	VV	SW
DATE	DATE	DATE	DATE	DATE
NOV 18	NOV 18	NOV 18	NOV 18	NOV 18
DIMENSIONS IN MILLIMETRES				NTS
LEVELS IN METRES				

LCOL181002-00-004 A

